

SERIES II MINI TRANSMITTER INSTRUCTIONS

1 IMPORTANT INFORMATION

NOTE: USE ONLY WITH **SERIES II** ELECTRONICS.

Older Transmitters will not work with these new electronics. There are no Security Code Switches inside the Door Operators or Transmitters.

⚠ WARNING	
	<p>Moving Door can cause serious injury or death.</p> <ul style="list-style-type: none"> • Do Not install remote unless the door operator's safety reverse works as required by the door operator's manual. • Wall control must be mounted in sight of door, at least 5 feet above floor and clear of moving door parts. • Keep people clear of opening while door is moving. • Do Not allow children to play with the transmitter or door operator. <p>If safety reverse does not work properly:</p> <ul style="list-style-type: none"> • Disconnect operator using the manual release handle. • Do Not use transmitter or door operator. • Refer to Door and Door Operator Owner's Manuals before attempting any repairs.
	<p>Electrical Shock can cause serious injury or death.</p> <ul style="list-style-type: none"> • Power cord must be unplugged before attaching any wires. • Be sure wire ends do not touch each other or other terminals. <p><small>If you have questions or if you need a manual, contact the distributor or manufacturer of the operator.</small></p>

2 TO PROGRAM THE RECEIVER

A different Transmitter Code is set at the factory for each Transmitter.

Locate the Receiver Learn Code Button and Flash Indicator on the Power Head of your Door Operator.

Step 2-1 Press and release the Receiver Learn Code Button. *Fig. 1*

- The Receiver Flash Indicator will flash approximately 2 times per second.
- Perform Step 2-2 within 30 seconds for programming to continue. If programming stops, return to Step 2-1.

Step 2-2 Press Transmitter Button once.

- Transmitter Code is sent to the Receiver.
- The Receiver Flash Indicator stays lit (solid) – the Receiver has received a valid Transmitter Code.
- Perform Step 2-3 within 30 seconds. If Transmitter Code is not confirmed within 30 seconds or if a different Transmitter Code is sent, the Receiver Flash Indicator will flash approximately 4 times per second, then programming will stop. If programming stops, return to Step 2-1.

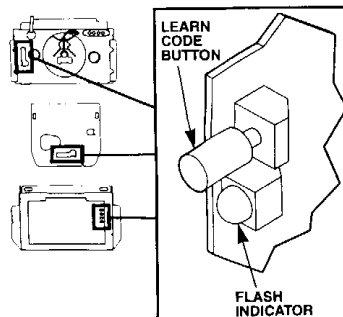

Fig. 1

Step 2-3 Press same Transmitter Button to confirm the Transmitter Code.

- The Receiver Flash Indicator light will go out.
- The Transmitter Code is now stored in Receiver memory.

Step 2-4 Return to Step 2-1 for each transmitter to be learned.

NOTE: A MAXIMUM OF 7 TRANSMITTER CODES CAN BE STORED INTO RECEIVER MEMORY AT ONE TIME. If a Transmitter becomes lost, or more than 7 Transmitter Codes are attempted to be learned to a single Receiver, proceed to 4 TO ERASE ALL TRANSMITTER CODES FROM THE RECEIVER MEMORY, Step 4-1.

3 MULTI-BUTTON TRANSMITTERS

NOTE: Only ONE button of a Multi-Button Transmitter can be programmed into a single Power Head Receiver.

4 TO ERASE ALL TRANSMITTER CODES FROM THE RECEIVER MEMORY

Step 4-1 Press and HOLD the Receiver Learn Code Button for approximately 10 seconds.

- Light goes out.

All Transmitter Codes are erased from the Receiver memory.

Step 4-2 Return to 2 TO PROGRAM THE RECEIVER, Step 2-1.

5 TRANSMITTER OPERATION

- Point Transmitter at the garage door and press the button. Door will move.
- Press the Transmitter Button again and the door will stop.
- Press the Transmitter Button again and the door will move the other way. The door automatically stops at the end of the open or close cycle.

6 VISOR CLIP/BATTERY INSTALLATION

Step 6-1 Battery replacement (your Transmitter is battery powered).

- Remove screw from back of Case.
- Separate Front and Back Case halves.
- Install new battery in same position – use Eveready A23, 12 Volt (lighter type).
- Replace Front Case and screw.

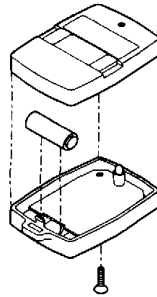

Fig. 2

NOTE: If you are replacing a lost or stolen transmitter: (1) Erase all Transmitter Codes from the Receiver memory. (2) Reprogram the Receiver with the remaining Transmitters Codes.

FCC and IC CERTIFIED
This device complies with FCC Part 15 and RSS 210 of Industry Canada. Operation is subject to the following two conditions: (1) This device may not cause harmful interference, and (2) this device must accept any interference, including interference that may cause undesired operation of the device.

Changes or modifications not expressly approved by the manufacturer could void the user's authority to operate the equipment.

**For additional information or help, see Owner's Manual or contact Customer Service:
1-800-OK-GENIE**

**Customer Service
22790 Lake Park Blvd.
Alliance, Ohio 44601-3498**